

PREPARED FOR  
JAMIE LESKA  
2604 SOUTH SHORE DR.  
DELAVAN WI 53115

# PLAT OF SURVEY

-OF-

LOT 7, BLOCK 1 AND THE SOUTHWESTERLY 1/2 OF LOT 6,  
BLOCK 1, OF DELMAR SUBDIVISION LOCATED IN TOWN 2  
NORTH, RANGE 16 EAST, WALWORTH COUNTY, WISCONSIN.

KROTT SURVEYING INC.

N3705 WILLOW BEND LANE  
LAKE GENEVA WI. 53147  
PHONE # (262)248-3697  
FAX # (262)249-0639

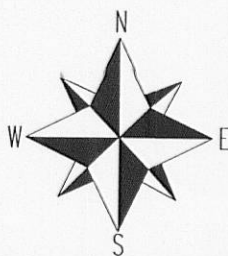
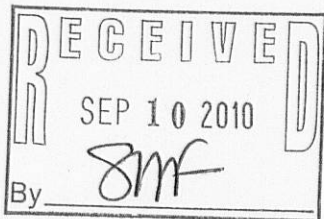

SCALE 1" = 20'

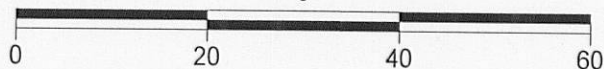

I have surveyed the above-described property and the above map is a true representation thereof and shows the size and location of the property, its exterior boundaries, the location and dimensions of all structures thereon, fences apparent easements and roadways and visible encroachments, if any.

This survey is made for the exclusive use of the present owners of the property, and also those who purchase, mortgage, or insure the title thereto within one (1) year from date hereof; and as to them I warrant the accuracy of said survey map.

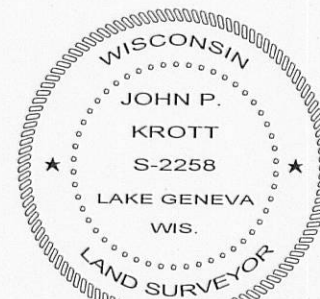

DATED THIS 24th DAY OF AUGUST 2010.

*John P. Krott*

JOHN KROTT S - 2258  
Wisconsin Registered Land Surveyor  
(original if signed in red.)

## LEGEND

- FOUND IRON PIPE
- FOUND IRON BAR
- Ø UTILITY POLE

(XX) RECORDED AS

TAX ID # FDM00002D

JOB # 10-142